

# FRANKE DESIGNER CATALOG

2017



MAKE IT WONDERFUL

**FRANKE**



It's easy to be ordinary; to have an ordinary home, filled with things you neither love nor hate. But you should never settle for ordinary and that's why we want to make everything we make wonderful. Wonderful turns a house into a home and turns work into play. Every Franke product aims to be wonderful in every way; from the first glimpse of carefully considered design, to manufacturing standards that ensures you can feel the quality and craftsmanship of every piece.

This catalogue captures the spirit of wonderful in order to captivate and inspire you. A comprehensive range of sinks, taps, hobs, decorative hoods, kitchen appliance and accessories can help turn an everyday kitchen extraordinary and turn a daily chore into a guilty pleasure.

Let everyone else be ordinary. Let's make it wonderful.

# Introduction



Franke Headquarters in Aarburg, Switzerland

Since 1911, Franke has been known for its dedication to research, development, manufacture and service. Today, it is one of the world's leading suppliers of kitchen sinks, taps, cooking hobs and extractor hoods.

# GLOBAL FOOTPRINT



Aarburg, April 3, 2017, The Franke Group 1 achieved a pleasing increase in sales and significantly improved profitability in 2016, despite a challenging global economy. The sales growth was driven mainly by strong organic growth in the double-digit percentage range. The higher profitability is based on sales rises in practically all of the divisions and on group-wide operating efficiency improvements. Thanks to a solid strategic foundation and additional investments in innovation and employees, the Group was able to gain additional market shares. Furthermore, by reacting more quickly to business opportunities it could strengthen its market position further despite a tough, competitive environment.

**Franke belongs to the Artemis Group and is a world leading provider of solutions and equipment for residential kitchens and bathrooms, public/private washrooms, the professional foodservice sector, and coffee preparation. The Franke Group operates worldwide and employs around 9,000 people in 40 countries, generating sales of over CHF 2.0 billion.**

## Franke Artemis Group Core Businesses

## Global Position

FRANKE KITCHEN SYSTEMS		No. 1
FRANKE FOOD SERVICE SYSTEMS		No. 1
FRANKE COFFEE SYSTEMS		No. 2
FRANKE WATER SYSTEMS		No. 3
FRANKE BEVERAGE SYSTEMS		No. 1



# ADVANTAGE FRANKE - High Grade Materials

## TECTONITE®

Made in The Netherlands.

TECTONITE® is the latest innovation by Franke – made of TECTONITE®, which is a hi-tech, light but strong synthetic material that gives you amazing advantages:

- It is extreme temperature resistant (230-300 degrees)
- It is scratch resistant and has a super smooth and easy to clean texture
- It is resistant to chemicals used in the kitchen (vinegar, tomato sauce, etc.)
- It has a UV resistant coating (its colour will not change)
- It is a 100% recyclable material
- It is available in three high tech colours: carbon black, arctic white and coffee
- It has a five year warranty



## TECTONITE® Technology



### Beautiful and Strong

A great looking and smooth surface, the TECTONITE® material prevents scuffing or scratching. It is also easy to clean and doesn't lose colour.



### 3rd Generation Coating

A new coating called PiMC (Power in Mold Coating) gives a protective layer providing strength to the material and protecting its colour.



### Exclusive Texture

It is finished with an exclusive texture that coats the sink and repels water and dirt to keep the surface looking as good as new.



## AUSTENITIC STAINLESS STEELS (SS 304 - AUSTENITIC GRADE)

All Franke Stainless steel sinks are manufactured using only SS 304 Austenitic grade. Austenitic stainless steel are chromium & nickel containing stainless steel with very low carbon content. Austenitic 304 stainless steels formed through the generous use of austenitizing elements such as nickel, manganese and nitrogen. Chromium content is range of 18% and nickel content in range of 8%. They are non-magnetic but can become slightly magnetic when cold worked. Cold working also enhances their strength. Austenitic stainless steel have mechanical properties over a wide range of temperatures. In addition, these steel are easy to clean, which enhances their use in applications in hygienic and sterile environments.



### 18/10: 18% Chromium and 10% Nickel

This material is used in Neptune



### 18/8: 18% Chromium and 8% Nickel

This material is used in 610/611, 620, 621, 651 and Adrian Series



---

# SUPERIOR FINISHES & PERFORMANCES

---



### Microdecor Finish

The distinctive pattern of Microdecor steel is so light as to be almost invisible, recalling the effect of aluminum and giving the steel a unique, inimitable appearance. Any scratches only damage the tiny convex areas of the surface, while the imperceptible concave zones prevent the formation of visible marks.



### European Satin Finish

Franke uses a unique process of brush polishing on CNC controlled latest technology machine along with special "Franke" ATL-F22 paste that gives product surface a smooth European Satin finish with good aesthetic look. This makes it best suitable for all kitchen applications since it is prone to scratching during daily usages.

---

## Warranty

---

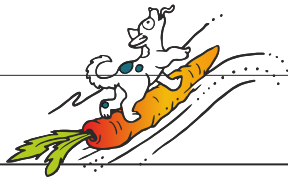

### 25 Year Warranty

All Franke Stainless Steel Sinks are guaranteed for 25 Year against faulty workmanship and material.



### 5 Year Warranty

All Franke Color Sinks are guaranteed for 5 Year against faulty workmanship and material.



### 1 Year Warranty

All Franke Taps, Bio Waste Disposer & Accessories are guaranteed for 1 Year against faulty workmanship and material.





BALI SINK





## FRAGRANITE

Following extensive testing and development, new Fraganite tackles the humble cleaning problem associated with composite sinks. The revolutionary new Fraganite+ technology is now available on all Franke Fraganite and SilkSheen Fraganite sinks, which now enjoy ultra-smooth surfaces that are exceptionally easy to keep clean.

Kitchens can be a fertile breeding ground for bacteria, mold and mildew, which can lead to material damage and cause unpleasant odours and stains. On unprotected material, bacteria levels can increase every 20 minutes. The integrated Sanitized® protective function in Fraganite sinks helps to keep this area clean and provides the sink with lasting protection. It does not replace normal cleaning practices, but helps to keep surfaces clean. Fraganite treated with Sanitized® reduces bacterial odours by 99%. Sanitized® protective function helps to keep sink surfaces clean by reducing the growth of bacterial odours, mold and mildew even between cleanings.

The granite particles bonded together during manufacture are now smaller, creating a smoother, flatter surface, reducing the chances for limescale to build up. It is also far more difficult for residue, food particles and bacteria to accumulate in between the granules, which greatly improves hygiene.

Tested against leading competitors, DuraKleen® Plus comes up trumps on stain resistance. Even after being left to sit on the sink for 18 hours, the toughest stains like beetroot, permanent marker, red wine and iodine can simply be wiped clean away.





## SANITIZED®



With all the foodstuff around in both raw and cooked states and at various stages of the process of cooking, kitchens are an obvious breeding ground for bacteria. Therefore, as an area that's critical to keep clean and bacteria-free, they need special attention to be paid to them.

On unprotected material, bacteria can multiply every 20 minutes and have a seriously adverse effect on hygiene. The possibility of transferring bacteria is also higher on untreated material. Which is why we have designed our Fraganite sinks with an integrated Sanitized® hygiene function. This helps to keep the area clean and provides the sink with lasting protection. It does not replace normal cleaning but helps to keep surfaces free from bacteria. Tests have proven that Fraganite treated with Sanitized® reduces bacteria and microbe growth by as much as 99%.

Sanitized® also helps to keep the sink surface hygienic and protected from bacteria and microbe growth after and in between normal cleaning cycles. So, all in all, you have an almost-bacteria-free washing-up area.

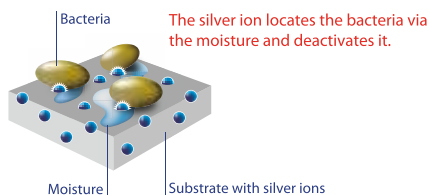





# FRAGRANITE

Staining agent	Ease of cleaning
Coffee	Cold water
Red wine	Cold water
Olive oil	Cold water
Oven cleaner	Cold water
Ketchup	Cold water
Coca-Cola	Cold water
Silver shine	Cold water
Vinegar	Cold water
Bleach	Cold water
Shoe polish	Cif + hot water
Beetroot	Cold water
Saffron	Cold water
Marker	Cif + hot water + 1 min
Mustard	Cif + cold water
Iodine	Cif + hot water + 30sec

## MATERIAL CHART

Fragranite / SilkSheen	
Heat	8
Scratch	9
Impact	8
Stain	8
Repair	4
Hygiene	9
Guarantee	10
<b>Total</b>	<b>56</b>

This chart has been developed by Franke to assist in grading the various materials in terms of their performance characteristics for each category.

It is intended to act as a guide for different requirements: 10 points - the best material tested in this performance category. For example, in our tests Fraganite/SilkSheen scores highly in scratch resistance and hygiene.

# BALI-65 1

**Description:** BLG 651-86 3 1/2" NWK REV NOF GP

**Finish:** Graphite

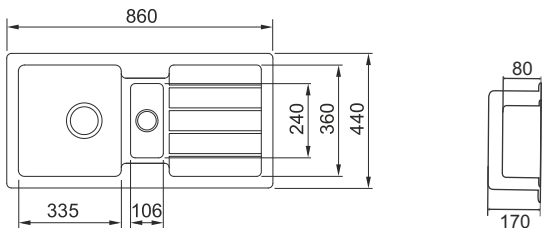

Fun	Dimensions (LxW) inch/mm	Bowl Size (LxWxD) inch/mm
114.0335.429	34x17.5/860x440	13.2x14.2x7/335x360x170
		6.3x12.6x4.7/106x240x80

**Description:** BLG 651-86 3 1/2" NWK REV NOF DB

**Finish:** Dark Brown

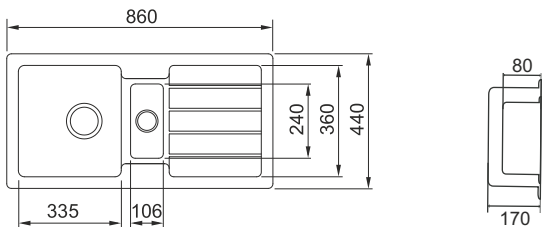

Fun	Dimensions (LxW) inch/mm	Bowl Size (LxWxD) inch/mm
114.0335.426	34x17.5/860x440	13.2x14.2x7/335x360x170
		6.3x12.6x4.7/106x240x80

**Description:** BLG 651-86 3 1/2" NWK REV NOF OA

**Finish:** Oat Meal

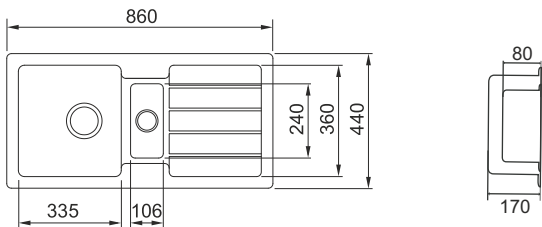

Fun	Dimensions (LxW) inch/mm	Bowl Size (LxWxD) inch/mm
114.0335.423	34x17.5/860x440	13.2x14.2x7/335x360x170
		6.3x12.6x4.7/106x240x80

# BALI-611

**Description:** BLG 614 3 1/2" NWK REV Mgraphite

**Finish:** Graphite

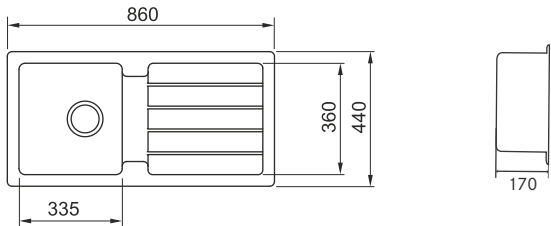

Fun	Dimensions (LxW) inch/mm	Bowl Size (LxWxD) inch/mm
114.0256.706	34x17.5/860x440	13.2x14.2x7/335x360x170

**Description:** BLG 614 3 1/2" NWK REV MDark brown

**Finish:** Dark Brown

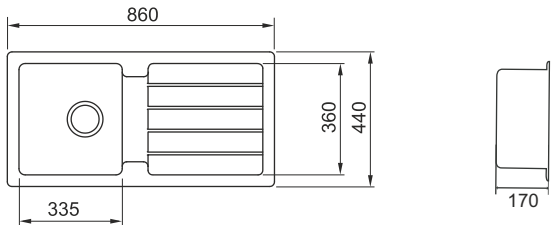

Fun	Dimensions (LxW) inch/mm	Bowl Size (LxWxD) inch/mm
114.0256.705	34x17.5/860x440	13.2x14.2x7/335x360x170

**Description:** BLG 614 3 1/2" NWK REV Goatmeal

**Finish:** Oat Meal

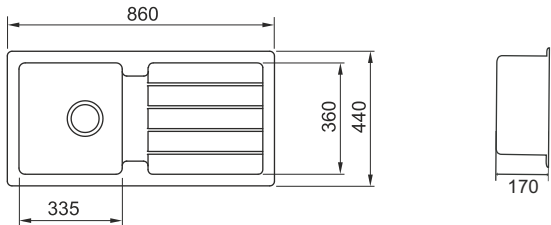

Fun	Dimensions (LxW) inch/mm	Bowl Size (LxWxD) inch/mm
114.0256.707	34x17.5/860x440	13.2x14.2x7/335x360x170



Tectonite 610

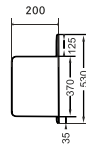
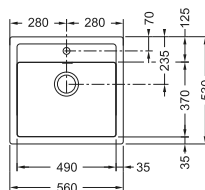

Fun	Dimensions (LxW)mm	Bowl Size (LxWxD)mm
Carbon Black 114.0279.873	560x530	490x370x200

Tectonite 611

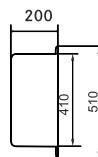
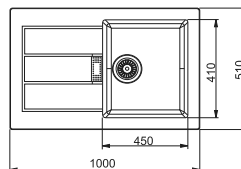

Fun	Dimensions (LxW)mm	Bowl Size (LxWxD)mm
Carbon Black 114.0253.151	1000x510	450x410x200

Tectonite 651

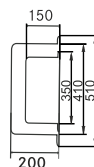
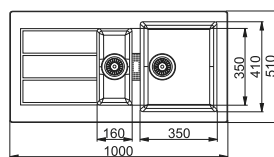

Fun	Dimensions (LxW)mm	Bowl Size (LxWxD)mm
Carbon Black 114.0253.160	1000x510	Big 350x410x200 & Small 160x350x150

Tectonite 621

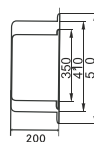
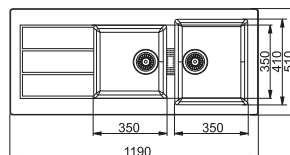

Fun	Dimensions (LxW)mm	Bowl Size (LxWxD)mm
Carbon Black 114.0253.281	1190x510	Big 350x410x200 & Small 350x350x200

## NEPTUNE - Microdecor Finish

---





# NEPTUNE - Microdecor Finish

## NET 611

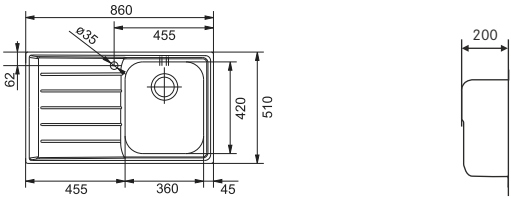

Fun	Dimensions (LxW)mm	Bowl Size (LxWxD)mm
RHD 101.0262.014	860x510	360x420x200
LHD 101.0262.013	860x510	360x420x200

## NET 651

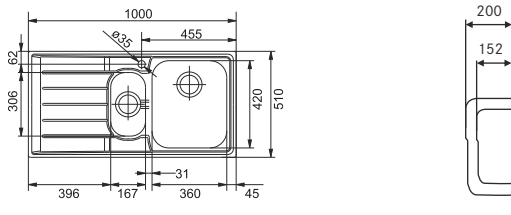

Fun	Dimensions (LxW)mm	Bowl Size (LxWxD)mm
RHD 101.0253.263	1000x510	Big 360x420x200, Small 167x306x152
LHD 101.0261.836	1000x510	Big 360x420x200, Small 167x306x152

## NET 621

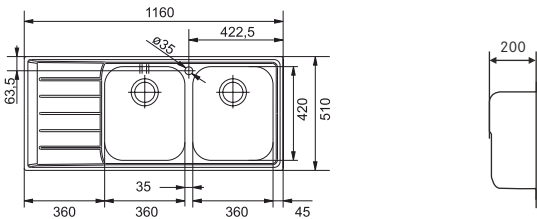

Fun	Dimensions (LxW)mm	Bowl Size (LxWxD)mm
RHD 101.0253.262	1160x510	360x420x200
LHD 101.0261.835	1160x510	360x420x200

# BELL - European Satin Finish

## BCX 610-61

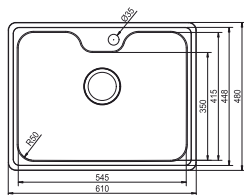

Fun	Dimensions (LxW) inch/mm	Bowl Size (LxWxD) inch/mm
101.0393.024	24x19.2/610x480	21.5x13.7x7.8/545x448x200

## BCX 610-81

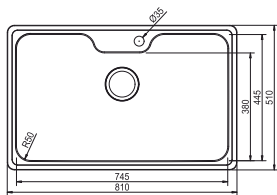

Fun	Dimensions (LxW) inch/mm	Bowl Size (LxWxD) inch/mm
101.0393.025	32x20/810x510	13.2x14.2x7/745x445x200

## BCX 620-38/32

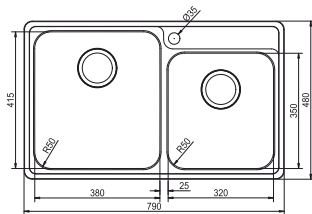

Fun	Dimensions (LxW) inch/mm	Bowl Size (LxWxD) inch/mm
101.0393.027	31x19/790x480	15x16.3x7/380x415x180 & 12.6x13.7x6.3/320x350x160

# LUGANO - European Satin Finish



## LUX 610

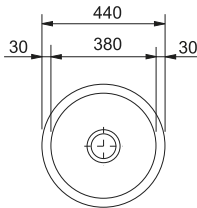

Fun	Diameter ( Ø)mm	Bowl Size ( Øx depth) mm
101.0253.181	440	380x190

---

## I PLANER - Square Sink European Satin Finish

---



# I PLANER - Square Sink European Satin Finish

## PIX-610-43

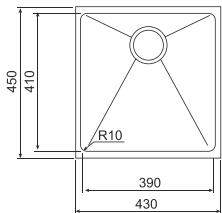

Fun	Dimensions (LxW) mm	Bowl Size (LxWxD) mm
101.0365.678	430x450	390x410x200

## PIX-610-53

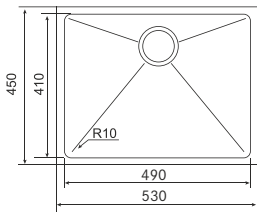

Fun	Dimensions (LxW) mm	Bowl Size (LxWxD) mm
101.0342.610	530x450	490x410x200

## PIX-610-83

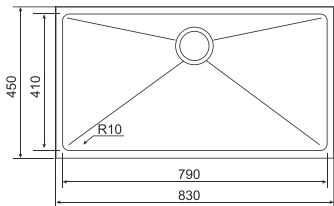

Fun	Dimensions (LxW) mm	Bowl Size (LxWxD) mm
101.0369.275	830x450	790x410x200

---

## ADRIAN\* - Microdecor / European Satin Finish

---





# ADRIAN\* - Microdecor / European Satin Finish

## ADRIAN 611 Omni (Microdecor Finish)

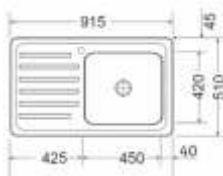

Fun	Dimensions (LxW) inch/mm	Bowl Size (LxWxD) inch/mm
101.0250.149	36x20/915x510	18x17x8/450x420x200

## ADRIAN 621 Trendy (Microdecor Finish)

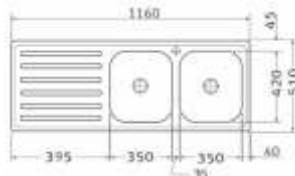

Fun	Dimensions (LxW) inch/mm	Bowl Size (LxWxD) inch/mm
101.0250.781	46x20/1160x510	14x17x7/350x420x180

## ADRIAN 611 Omni (European Satin Finish)

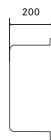
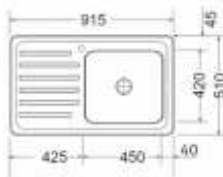

Fun	Dimensions (LxW) inch/mm	Bowl Size (LxWxD) inch/mm
101.0258.689	36x20/915x510	18x17x8/450x420x200

## ADRIAN 621 Trendy (European Satin Finish)

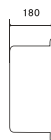
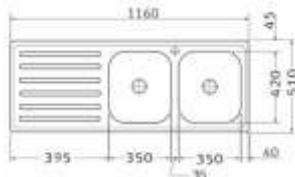

Fun	Dimensions (LxW) inch/mm	Bowl Size (LxWxD) inch/mm
101.0258.710	46x20/1160x510	14x17x7/350x420x180

\*Premium collection

# 610 SERIES\*- European Satin Finish

## 610 X Trendy (19 x 16)

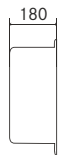
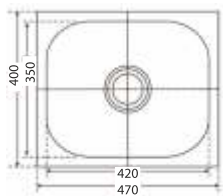

Fun	Dimensions (LxW) inch/mm	Bowl Size (LxWxD) inch/mm
101.0152.868	19x16/470x400	17x14x7/420x350x180

## 610 X Insti (21 x 18)

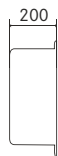
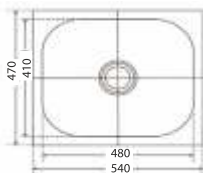

Fun	Dimensions (LxW) inch/mm	Bowl Size (LxWxD) inch/mm
101.0153.081	21x18/540x470	19x16x8/480x410x200

## 610 X Grand (24 x 18)

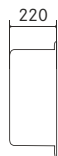
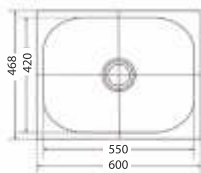

Fun	Dimensions (LxW) inch/mm	Bowl Size (LxWxD) inch/mm
101.0153.088	24x18/600x468	22x17x9/550x420x220

\*Premium collection series

# 611 SERIES\*- European Satin Finish

## 611 X Trendy (32 x 20)

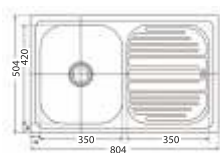

Fun	Dimensions (LxW) inch/mm	Bowl Size (LxWxD) inch/mm
101.0153.107	32x20/804x504	14x17x7/350x420x180

## 611 X Omni (36 x 20)

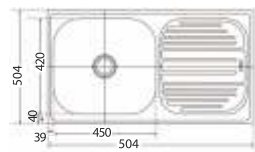

Fun	Dimensions (LxW) inch/mm	Bowl Size (LxWxD) inch/mm
101.0153.112	36x20/904x504	18x17x8/450x420x200

## 611 X Omni (40 x 20)

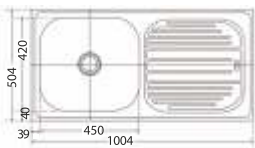

Fun	Dimensions (LxW) inch/mm	Bowl Size (LxWxD) inch/mm
101.0153.116	40x20/1004x504	18x17x8/450x420x200

# 620/651 SERIES\*- European Satin Finish

## 620 X Omni (40 x 20)

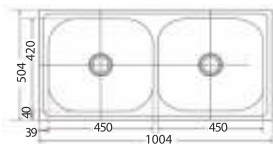

Fun	Dimensions (LxW) inch/mm	Bowl Size (LxWxD) inch/mm
101.0153.137	40x20/1004x504	18x17x8/450x420x200

## 620X Grand (48 x 20)

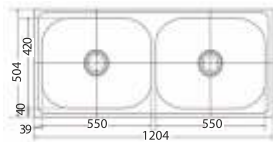

Fun	Dimensions (LxW) inch/mm	Bowl Size (LxWxD) inch/mm
101.0153.141	48x20/1204x504	22x17x9/550x420x220

## 651X Trendy (40 x 20)

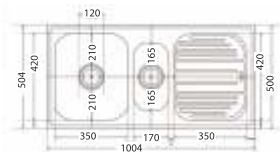

Fun	Dimensions (LxW) inch/mm	Bowl Size (LxWxD) inch/mm
101.0153.153	40x20/1004x504	Big 14x17x7/ 350x420 x180 Small 7x13x5/ 170x330x130

\*Indian premium collection series

# 621 SERIES\* - European Satin Finish

## 621X Trendy (47 x 20)

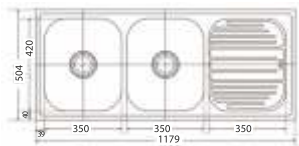

Fun	Dimensions (LxW) inch/mm	Bowl Size (LxWxD) inch/mm
101.0153.143	47x20/1179x504	14x17x7/350x420x180

## 621CX Omni (55 x 20)

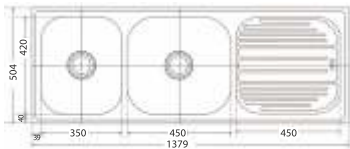

Fun	Dimensions (LxW) inch/mm	Bowl Size (LxWxD) inch/mm
101.0153.145	55x20/1379x504	Big 18x17x8/450x420x200
		Small 14x17x7/350x420x180

## 621 X Omni (59 x 20)

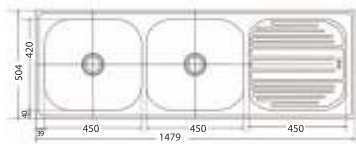

Fun	Dimensions (LxW) inch/mm	Bowl Size (LxWxD) inch/mm
101.0153.151	59x20/1479x504	18x17x8/450x420x200

# KITCHEN FAUCETS

## Body Material

Bronze (59-% - 63%), low lead content (0.8 % - 1.6 %) low residue (<1.5%) – gravity casting or low pressure casting.

Most products in the market are sand cased with lots of pinholes and uneven body thickness.

## Electroplating

The thickness of the nickel plating is more than international and European standards and more corrosion resistant than others.



Surface chrome plating thickness for Nickel and Chrome		
Franke	Nickel > 7.5u	Chrome >0.25 u
International Standard	Nickel > 5 u	Chrome > 0.1u
EN 817 / EN 200		

**Cartridge:** German Ceramic Cartridge and Longer Life

**Flexible hose:** Spanish S/S 304 exible hose, pressure resistant and corrosion resistant

**Aerator:** Using top grade Aerator, integrating water saving and water flow.

**Fasteners:** All using Stainless Steel



## RMD 891



Fun 115.0154.681

▷ PULL OUT TAP

## LLD821



Fun 115.0154.680

## M 507`C8



Fun 115.0083.496



# KITCHEN FAUCETS

CT 101S



Fun 115.0254.611  
Pull Out SS Tap

CT 103SE



Fun 115.0254.614  
SS Tap

CT 133S



Fun 115.0172.515  
Pull Out SS Tap

RT 505



Fun 115.0079.067

CT 903C



Fun 115.0176.532

CT 501C



Fun 115.0255.560

# COLD WATER TAP

## CT901S-CWO



FUN No : 115.0426.347

- Specification:
- Type: Side single lever kitchen faucet
  - Installation: Sink Mount
  - Material: Stainless steel 304 AISI
  - Surface: Inox Swiss Satin
  - Spout length: 215mm
  - Spout height: 275mm
  - Tap height: 335mm

## CT902S-CWO



Fun No : 115.0426.372

- Specification:
- Type: Side single lever kitchen faucet
  - Installation: Wall Mount
  - Material: Stainless steel 304 AISI
  - Surface: Inox Swiss Satin
  - Spout length: 215mm
  - Spout height: 240mm
  - Tap height: 300mm

# ACCESSORIES

## PLUMBING KIT SINGLE BOWL - 611



Fun	112.0156.034
-----	--------------

## PLUMBING KIT DOUBLE BOWL - 621



Fun	112.0156.044
-----	--------------

## ROLLER MAT



Size	Fun
366 x 438 mm	112.0058.824
400 x 400 mm	112.0050.988

# BIO WASTE DISPOSER

## Bio Waste Disposer 0.75 H.P.

This is a high output power Bio Waste Disposer with 0.75 HP motor. The lower speed but high output power delivers an ideal combination crunch with low noise. Crunch and Dispose the following down the drain for an easily-maintained and hygienic kitchen: fruit, vegetable peels, rice, soft chicken bones and egg shells.

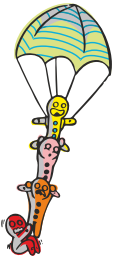
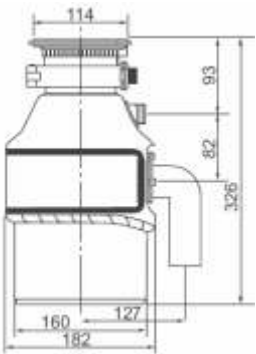

Model	FUN
Bio Waste Disposer	134.0041.549

### Features

- Fast grinding technology
- Corrosion proof stainless steel
- Manual reset for overload protection
- Handy wall stitch operation
- Easy and convenient installation
- Under cutter disk

### Materials

- Sink flange: stainless steel
- Hopper: glass filled nylon
- Swivel impeller: stainless steel
- Turntable: stainless steel

### Specication

- Motor speed: 1450 rpm
- Horsepower: 0.75 HP
- Rating Power 560W, 220V-250-V/50-60Hz
- Motor type: AC induction
- Type of feed: continuous
- Sound Shell: Yes
- Overload protection: manual reset
- Container: 1200 ml
- Diameter of standard sink hole: 90 mm
- Individual shipping weight: 6.3 kg

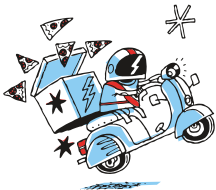

# FRANKE PRODUCTS PRICE LIST



<b>Indian Made Kitchen Sinks</b>			
<b>SAP Code</b>	<b>SAP Description</b>	<b>Description</b>	<b>MRP</b>
1010250.149	AYT 611-91-20 3 12" WWK REV WOF NTH	611MD Omni (36X20) Adrian - OF	12,790
1010250.781	AYT 621-116-18 3 12" WWK REV WOF NTH	621MD Trendy (46X20) Adrian - OF	22,990
1010258.689	AYX 611-90-20 3 12" WWK REV WOF	611X Omni (36X20) Adrain	9,190
1010258.710	AYX 621-116-18 3 12" WWK REV WOF NTH	621X Trendy (46X20) Adrian - OF	17,290
1010153.088	GRX 610-60-22 3 12" WWK NOF ND	610X Grand (24 X 18)	6,990
1010153.141	GRX 620-120-22 3 12" WWK NOF	620X Grand (48X20)	19,190
1010153.081	ISX 610 3 12" WWK NOF ND	610X Insti (21X 18)	5,790
1010153.116	OMX 611-100-20 3 12" WWK REV NOF	611X Omni (40X20)	9,290
1010153.112	OMX 611-90-20 3 12" WWK REV NOF	611X Omni (36X20)	8,490
1010153.137	OMX 620-100-20 3 12" WWK NOF	620X Omni (40X20)	16,290
1010153.145	OMX 621-137-20 3 12" WWK REV NOF	621CX Omni (55X20)	17,190
1010153.151	OMX 621-147-20 3 12" WWK REV NOF	621X Omni (59X20)	19,690
1010152.868	TRX 610 3 12" WWK NOF	610X Trendy (16 X 19)	4,890
1010153.107	TRX 6113 12" WWK REV NOF	611X Trendy (32X20)	7,790
1010153.143	TRX 6213 12" WWK REV NOF	621X Trendy (47X20)	15,690
1010153.153	TRX 6513 12" WWK REV NOF	651X Trendy (40X20)	14,590
112.0123.280	ASSEMBLED WASTE KIT	WASTE COUPLER ( FRANKE )	550
1010342.610	PIX 610-53 3 12" NWK ND NOF NTH	SINK I PLANAR 530	12,190
1010369.275	PIX 610-83 3 12" NWK ND NOF NTH	SINK I PLANAR 830	13,290
1010365.678	PIX 610-43 3 12" NWK ND NOF NTH	SINK I PLANAR 430	9,990

<b>Imported Kitchen Sinks</b>			
<b>SAP Code</b>	<b>SAP Description</b>	<b>Description</b>	<b>MRP</b>
1010253.181	LUX 610 3 12" NWK ND NTH BOX	LUX 610 NO OFL	7,500
1010262.013	NET 6113 12" WWK LHD FRL TH WOF LAB	NET 611(860X510) LHD	21,800
1010262.014	NET 6113 12" WWK RHD FRL TH WOF LAB	NET 611(860X510) RHD	21,800
1010253.262	NET 6213 12" WWK RHD FRL TH WOF BOX	NET 621(1160X510) RHD	31,200
1010261835	NET 6213 12" WWK LHD FRL TH WOF LAB	NET 621(1160X510) LHD	31,200
1010261836	NET 6513 12" WWK LHD FRL TH WOF	NET 651(1000X510) LHD	28,200
1010253.263	NET 6513 12" WWK RHD FRL TH WOF BOX	NET 651(1000X510) RHD	28,200
114.0253.151	SID 611-100 3 12" NWK NTH REV CB BOX	TECTONITE 611(1000X510)CB	16,400
114.0253.281	SID 6213 12" NWK NTH REV CarbonBlackBOX	TECTONITE 621(1190X510)CB	21,800
114.0253.160	SID 6513 12" NWK NTH REV CarbonBlackBOX	TECTONITE 651(1000X510)CB	18,400
114.0279.873	SID 610 312" WWK TH HOFTL Car.Black BOX	SID 610 312" WWK TH HOFTL Car.Black BOX	9,990
1010489.050	BCX 610-613 12" WWK OFS THEN	BCX 610-613 12" WWK OFS THEN	13,490
1010489.191	BCX 610-813 12" WWK OFS THEN	BCX 610-813 12" WWK OFS THEN	15,490
1010489.192	BCX 620-38-32 3 12" WWK OFS THEN	BCX 620-38-32 3 12" WWK OFS THEN	17,490
114.0483.653	BLG 614 3 12" WWK REV MDarkbrown	BLG 614 3 12" WWK REV MDarkbrown	13,490
114.0483.656	BLG 614 3 12" WWK REV MGraphite	BLG 614 3 12" WWK REV MGraphite	13,490
114.0483.657	BLG 614 3 12" WWK REV GOatmeal	BLG 614 3 12" WWK REV GOatmeal	13,490
114.0483.660	BLG 651-86 3 12" WWK REV NOF OA	BLG 651-86 3 12" WWK REV NOF OA	16,990
114.0483.681	BLG 651-86 3 12" WWK REV NOF DB	BLG 651-86 3 12" WWK REV NOF DB	16,990
114.0483.682	BLG 651-86 3 12" WWK REV NOF GP	BLG 651-86 3 12" WWK REV NOF GP	16,990
112.0498.609	Accessories BCX 610 – 61	Accessories BCX 610 – 61	4,500
112.0498.610	Accessories BCX 610 – 81	Accessories BCX 610 – 81	4,650



# FRANKE PRODUCTS PRICE LIST



<b>Taps &amp; Other Accessories.</b>			
<b>SAP Code</b>	<b>SAP Description</b>	<b>Description</b>	<b>MRP</b>
134.0041.549	Food waste disposer 303110 3/4 HP FSA	BIO FOOD DISPOSER	16,200
115.0255.560	Tap CT501C pro side HP chrome	Tap CT501C pro side HP chrome	7,890
115.0254.611	Tap CT 101S pro side HP satin	Tap CT 101S pro side HP satin	18,990
115.0254.614	Tap CT 103SE spout side HP satin	Tap CT 103SE spout side HP satin	12,990
115.0254.613	Tap CT 133S nozzle side HP satin	Tap CT 133S nozzle side HP satin	14,990
115.0176.532	Tap CT 903C spout side HP chrome	Tap CT 903C spout side HP chrome	9,990
115.0083.496	M 507 CB	Wall Mounted Sink Mixer	6,990
115.0426.347	CT901S CWO	SS Single Lever Sink Cold Water Tap	9,990
115.0426.372	CT902S CWO	SS Single Lever Wall Cold Water Tap	9,490
112.0073.191	Tap hole stopper s/s	Tap Hole Stopper	200
115.0154.680	Tap LLD821spout top LP	TAPS SWIVELINGSPOUT LP TOP LEVER (LLD821)	4,350
115.0154.681	Tap RMD891pull-out spray top LP	TAP SINGLE LEVER WITH PULL OUT SPRAY (RMD891)	8,150
115.0079.067	Tap rt505 spout side HP chrome	Tap RT 505-(220-566)	6,850
112.0050.988	C kitchen unit PPX,PZR'Rolling matt 400x	C kitchen unit PPX,PZR'Rolling matt 400x	3,000
112.0058.824	C kitchen unit PPX,PZR'Rolling matt 366x	C kitchen unit PPX,PZR'Rolling matt 366x	3,500
112.0266.314	Inox Cream 250 GR Tube	Inox Cream	550
112.0156.044	Plumbing kit DBowl grey space saver	DRAINER KIT-SINGLE (420-508)	990
112.0156.034	Plumbing kit SBowl grey economic exp	DRAINER KIT-SINGLE (420-508)	1,360





Regd. Office:

**FRANKE FABER INDIA PVT. LTD.**

Gat No.: 1086/1/2, Nagar Road,  
Sanaswadi, Tal Shirur, Pune - 412208,  
Maharashtra, India.

E-mail: [ks-appliances.in@franke.com](mailto:ks-appliances.in@franke.com)  
website: [www.franke.com](http://www.franke.com)  
CIN-U99999PN1997PLC107240

Manufacturing Plant:

**FRANKE FABER INDIA PVT. LTD.**

Plot No. L-7, MIDC, Waluj Industrial  
Area, Aurangabad-431136,  
Maharashtra, India.

E-mail: [ks-appliances.in@franke.com](mailto:ks-appliances.in@franke.com)  
website: [www.franke.com](http://www.franke.com)  
CIN-U99999PN1997PLC107240

Customer Care:

All India Toll Free Helpline No.: 1800 209 3484

E-mail: [ks-appliances.in@franke.com](mailto:ks-appliances.in@franke.com)

Follow us on: Facebook/[frankeindia](https://www.facebook.com/frankeindia)



**AUTHORISED DEALER**



Note: Features and specifications as shown may not be part of standard accessories and are subject to change without prior notice. All dimensions are approximate.